



# Airscrew 65 to 75 Airmax<sup>®</sup> Mixed Flow Fans

## General Mixed Flow Information

The characteristics of a Mixed Flow Fan combine the high flow of an Axial fan with the high pressure of a Centrifugal. It provides a solution where combined high pressure and flows are a requirement. The geometry of a Mixed Flow Fan provides a negligible stall characteristic and is ideally suited to applications such as cooling densely packed electronic equipment, or systems having high or variable resistance such as filters. Also, because of the impeller geometry, Mixed

Flow Fans produce less noise compared to Axial fans, making them ideal for use in crew or passenger areas.

The Airscrew range of Mixed Flow Fans comprises 400Hz, 1 or 3 phase induction motor drive, 28V DC or 270V DC brushless motor drives. The motor is integral with the fan to provide good heat transfer, optimum weight and size together with high reliability.

## 65 to 75 Airmax<sup>®</sup>

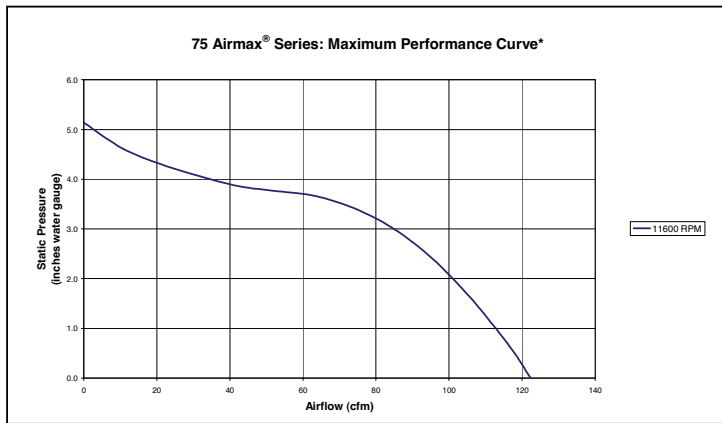

\*Individual Performance Curve Characteristics Available Upon Request

### General

- 65mm:
  - Physical Envelope: 3.7" x Ø4.1" (96mm x Ø104mm) typical<sup>1</sup>
  - Approximate Weight: 2.2lbs. (1Kg)
- 75mm:
  - Physical Envelope: 4.8" x Ø4.7" (122mm x Ø120mm) typical<sup>1</sup>
  - Approximate Weight: 3.3lbs. (1.5Kg)
- Airflows up to 254 CFM (120l/s)
- Pressures up to 16 IWG (4kPa)
- Custom mounting arrangements
- Meets the requirements of Mil Specs
- Twin Speed Options
- Thermal Sensing Options
- Optional Connectors/Flying Leads

<sup>1</sup> See specific part-number drawing for complete product dimensions

### Materials and Finishes

- Aluminum alloy impeller and casing— usually anodized dyed black
- Stainless steel shaft
- High precision, double shielded, Stainless Steel ball bearings (ABEC Class T)— maintenance free
- Stator wound to class H insulation
- Paint or anodize finishes

## Options/Accessories

- Twin Speed
- Speed Sensors
- Thermal Sensors
- Ceramic Bearings
- Finger Guards
- Helicoil Inserts

Specifications subject to change without notice



### Unit Description Key

The unit description key is for reference only and should not be confused with a part number. While most units are custom configurations, not all variations of the key shown below are possible. Please contact the Application Engineering department for more information regarding possible custom configurations.

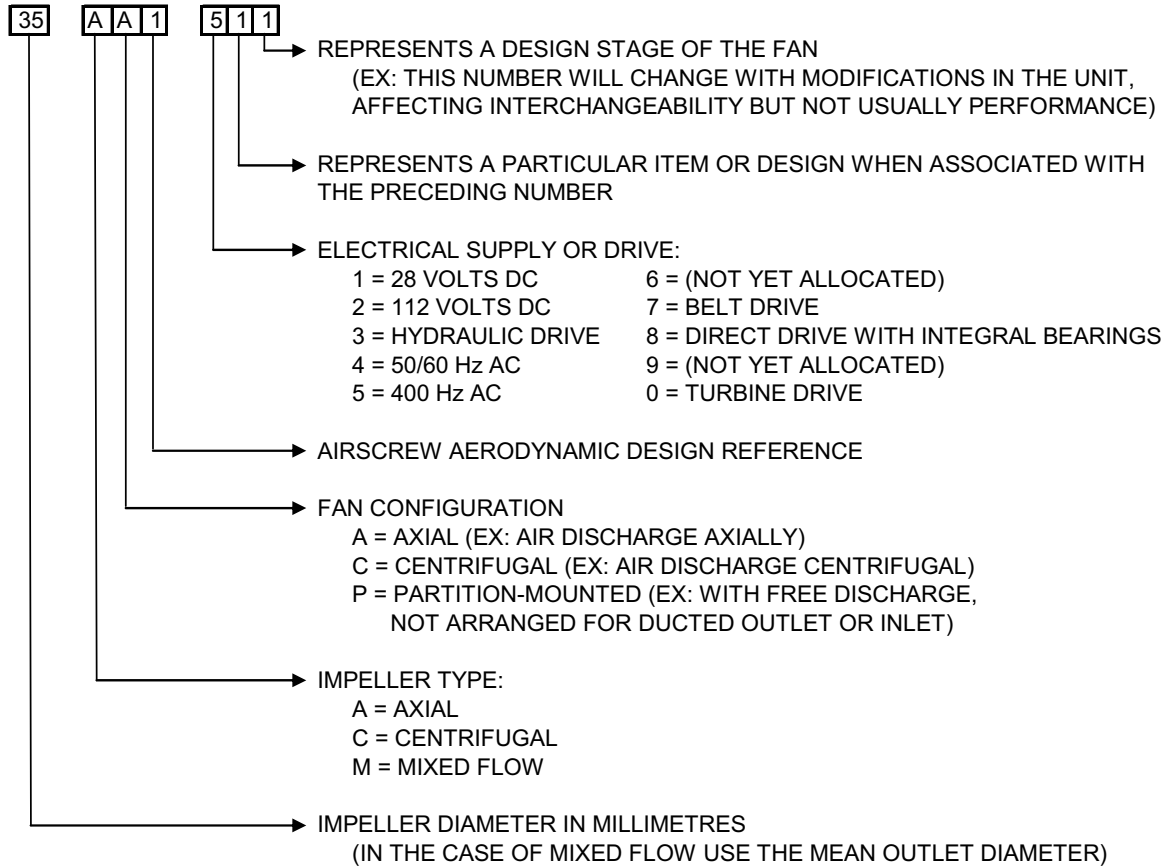

EXAMPLE: 35, AA1, 551

WHERE: 35 = 35MM IMPELLER DIAMETER, A = AXIAL IMPELLER, A = AIR DISCHARGE AXIALLY, 1 = AERODYNAMIC DESIGN REFERENCE, 5 = 400 Hz AC LINE ELECTRICAL SUPPLY, 1 = FIRST INSTALLATION DESIGN STAGE

### Ordering Information

When ordering, please specify the specific Airscrew part number listed on the model table below. Further ordering information, based on the configuration and motor series, may be obtained by contacting customer service. Please refer to the Unit Description Key explanation above.



Rotron / Airscrew



## Standard Product Offering of AC Line Powered Models

Part #	Prod Description	FLOW (CFM)	Max Pressure (IWG)	Nom RPM	Nom Watts	Line Amps (A)	Max Amb (C)	Weight (lbs)	Phase	Hz	Volts	Airflow Source Data
040197000	8060-1	64.03	2.99	11300	68.50	0.47	85	2.10	3	400	200	AS003-15
040184000	10720	150.44	12.37	21000	272.00	1.01	70	2.10	3	400	200	AS001-9
040265000	7301 MOD 1	239.97	15.79	22000	370.00	1.42	70	3.75	3	400	200	AS004-14
040185000	7540	284.00	15.79	22000	500.00	1.75	70	3.31	3	400	200	AS001-3
040150000	75-MA1-542	122.9	5.14	11500	74.00	0.51	90	2.94	3	400	200	AS005-11
040151000	75-MA1-551	226.72	18.68	22000	435.00	1.62	70	3.70	3	400	200	AS004-1
040156000	75-MA1-571	200.24	13.66	22000	320.00	1.28	70	4.00	3	400	200	AS004-23
040266000	75-MA1-572	229.98	15.99	22000	500	1.8	70	2.75	3	400	200	AS018-25
040159000	75-MA1-574	228.84	13.86	22000	465.00	1.61	70	4.00	3	400	200	AS004-2
040160000	75-MA1-575	254.27	13.66	22000	452.00	1.63	70	4.00	3	400	200	AS004-21
040267000	75-MA1-591	237.32	13.66	21000	400	1.5	70	3.75	3	400	200	AS019-13
040267000	75-MA1-591	122.9	3.21	11500	N/A	0.56	70	3.75	3	400	200	AS019-14

## Standard Product Offering of DC Line Powered Models

Part #	Prod Description	FLOW (CFM)	Max Pressure (IWG)	Nom RPM	Nom Watts	Line Amps (A)	Max Amb (C)	Weight (lbs)	Volts	Airflow Source Data
018025000	75-MA2-111	216.13	10.95	16000	230	8.2	70	3.50	28	AS004-3
018074000	75-MA2-112	132.33	8.23	16000	230	8.2	70	5.51	28	AS020-2
018087000	11304	134.97	6.55	16000	N/A	N/A	70	N/A	28	AS018-8

### A Typical 65 Airmax<sup>®</sup>

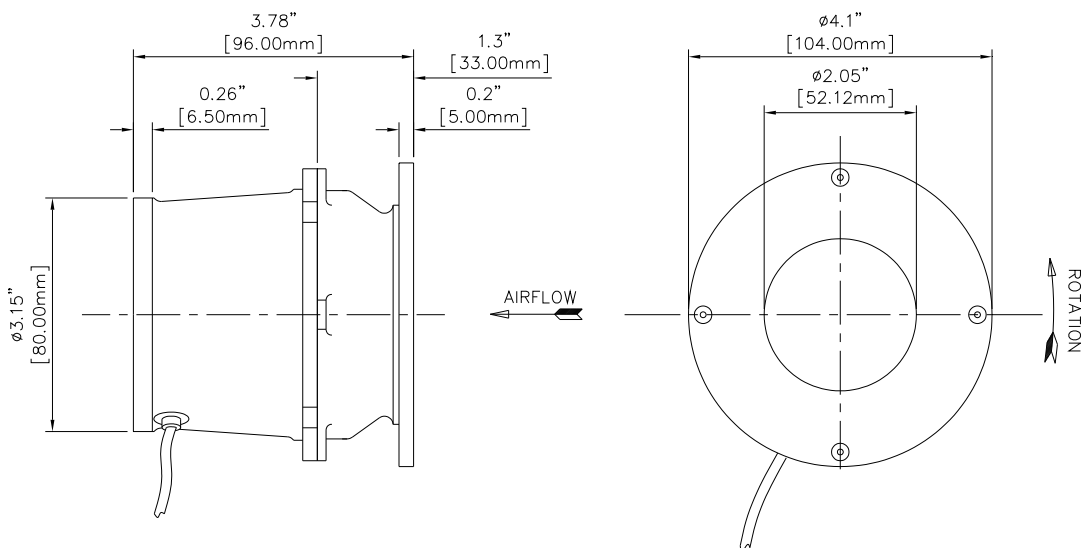

Specifications subject to change without notice



Rotron / Airscrew



### A Typical 75 Airmax<sup>®</sup>

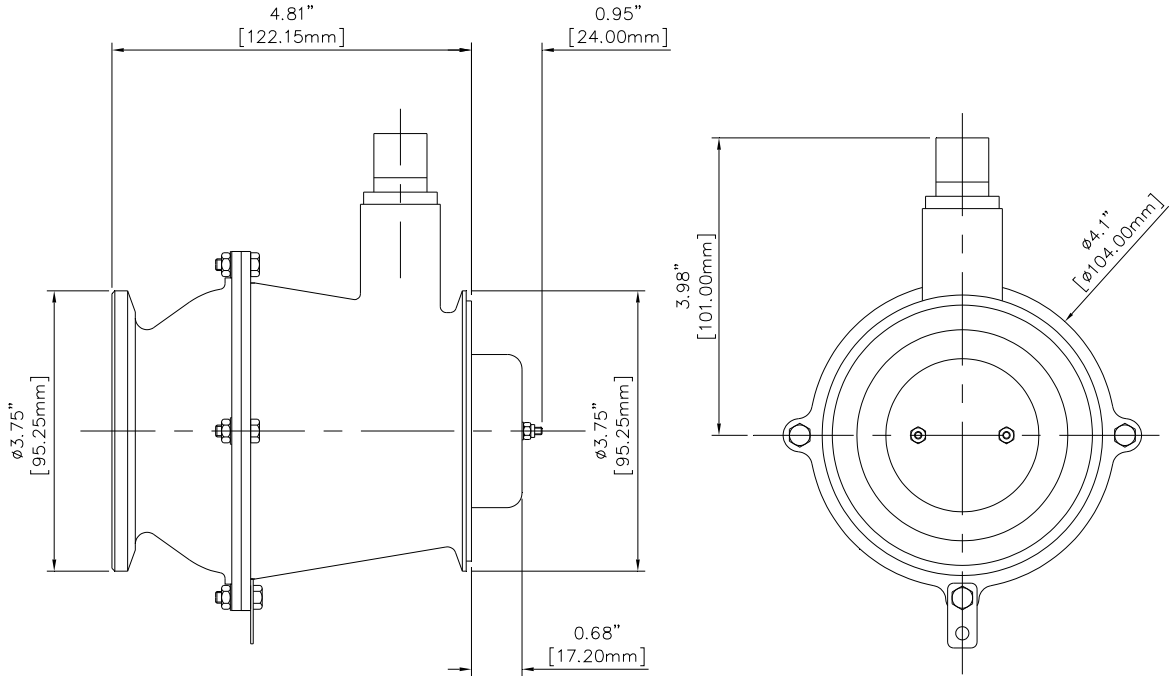

\*Part Number Specific Drawings Available Upon Request



Rotron / Airscrew



P/N 040197000 8060-1 AS003-15

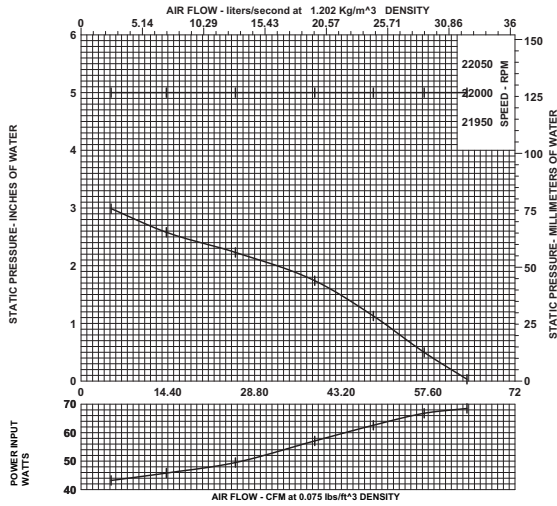

P/N 040184000 10720 AS001-9

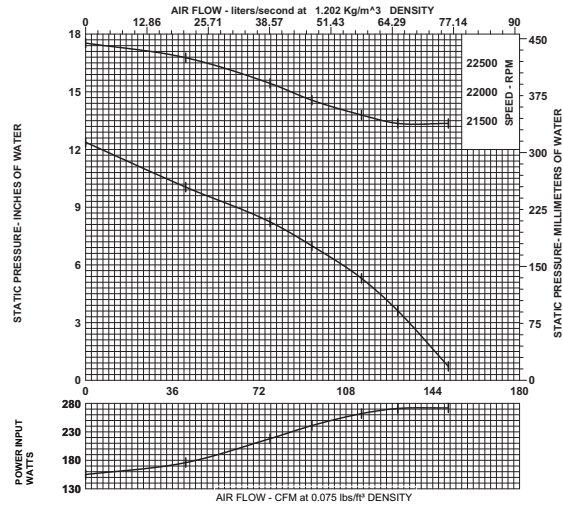

P/N 040265000 7301 MOD 1 AS004-14

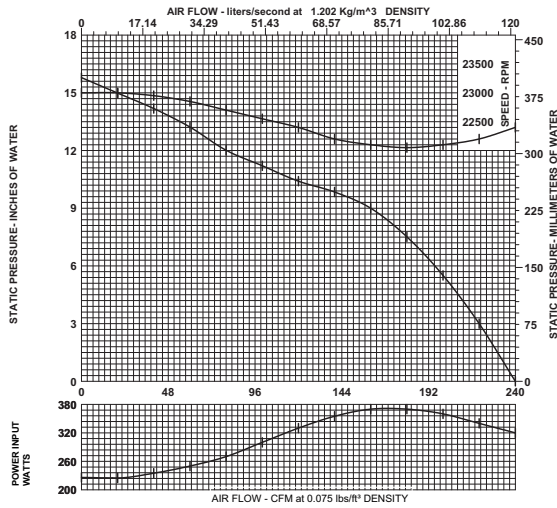

P/N 040185000 7540 AS001-3

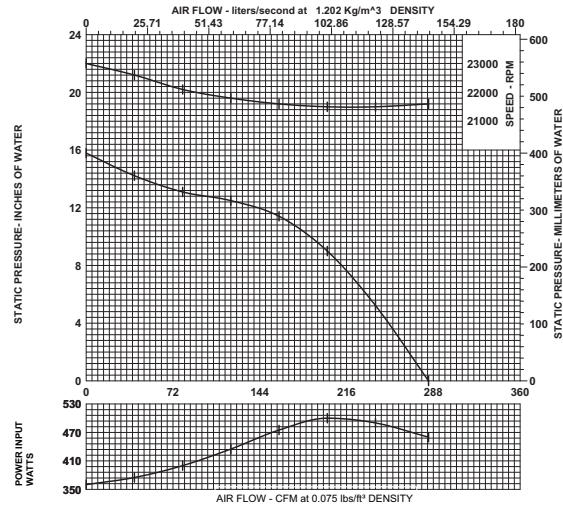

P/N 040150000 75-MA1-542 AS005-11

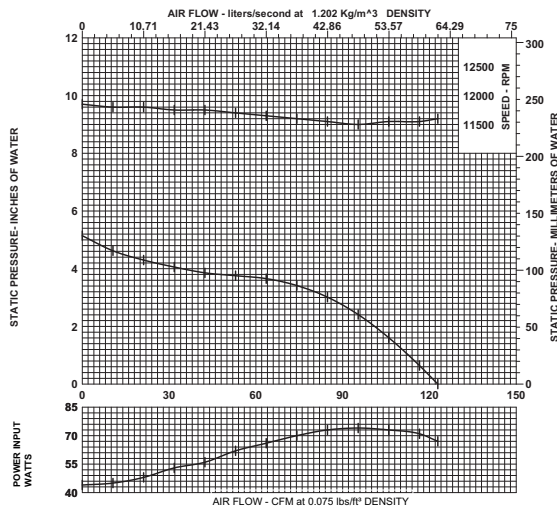

P/N 040151000 75-MA1-551 AS004-1

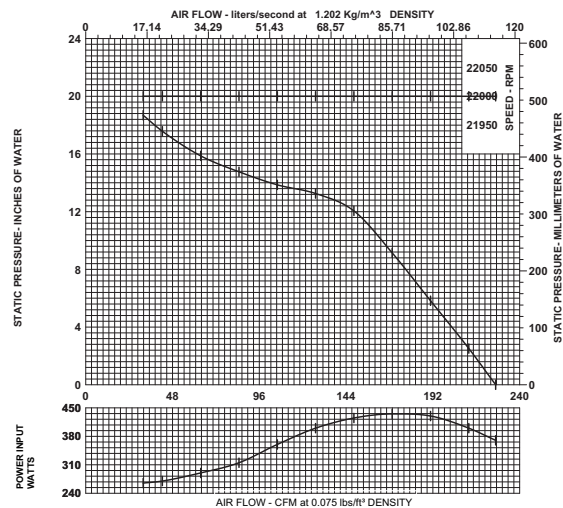

Specifications subject to change without notice



Rotron / Airscrew



P/N 040156000 75-MA1-571 AS004-23

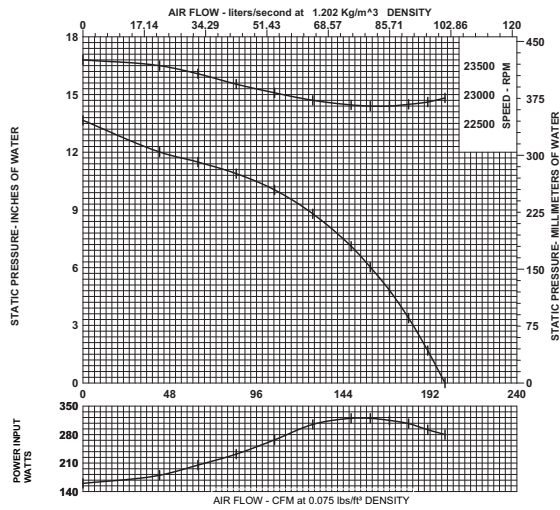

P/N 040266000 75-MA1-572 AS018-25

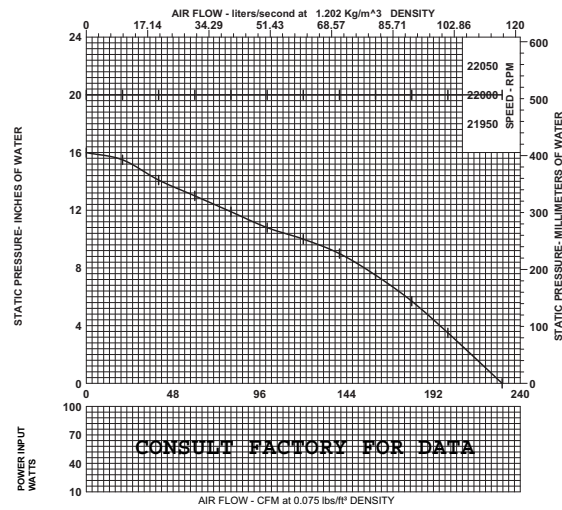

P/N 040159000 75-MA1-574 AS004-2

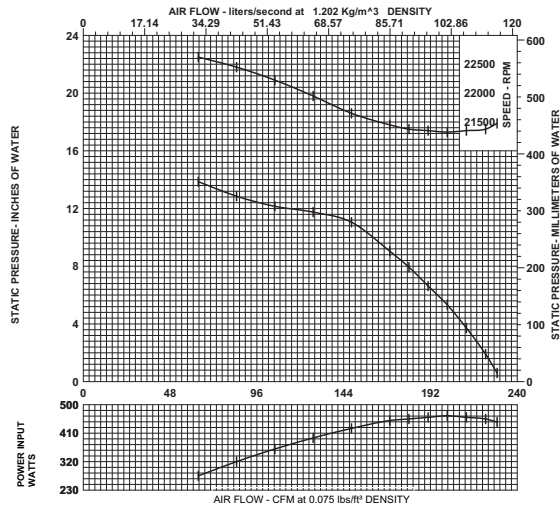

P/N 040160000 75-MA1-575 AS004-21

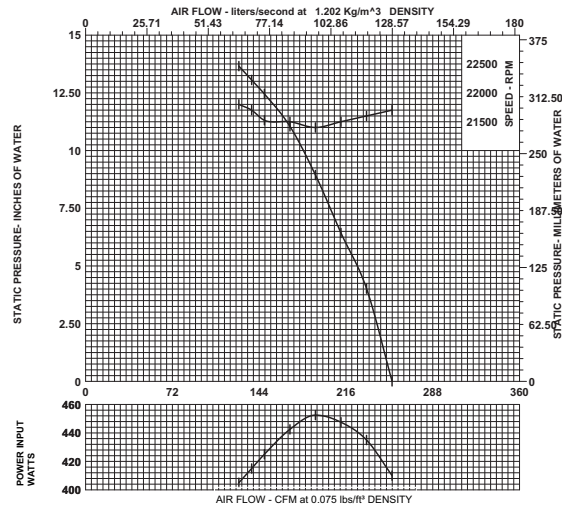

P/N 040267000 75-MA1-591 AS019-13

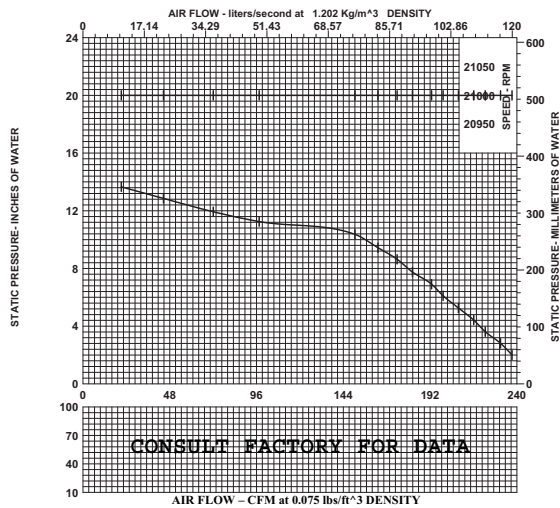

P/N 040267000 75-MA1-591 AS019-14

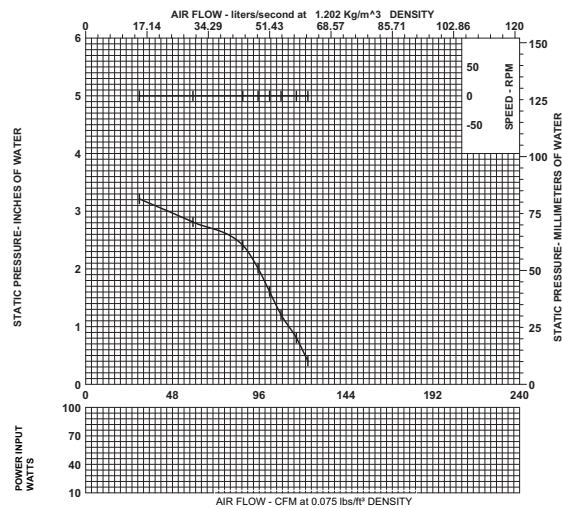

Specifications subject to change without notice



North America
T: +1 845-679-1361
F: +1 845-679-1870

United Kingdom
T: +44 (0) 1932 765822
F: +44 (0) 1932 761098

Europe
T: +49 8145 951767
F: +49 8145 951768

Asia Pacific
T: +65 6484 2388
F: +65 6481 6588

Contact E-mail: milinquiry@ametek.com

www.ametekaerodefense.com



Rotron / Airscrew



P/N 018025000 75-MA2-111 AS004-3

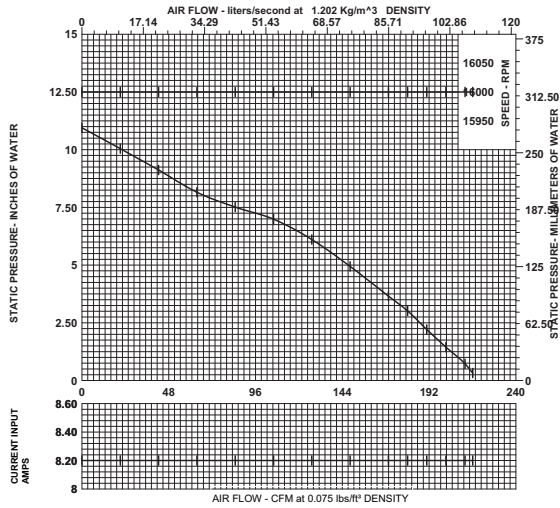

P/N 018074000 75-MA2-112 AS020-2

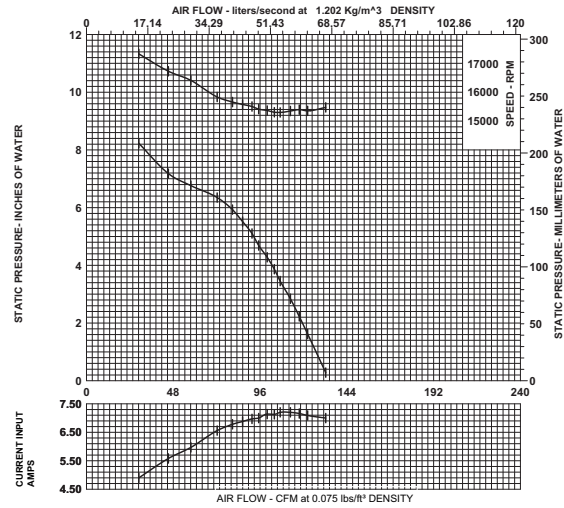

P/N 018087000 11304 AS018-8

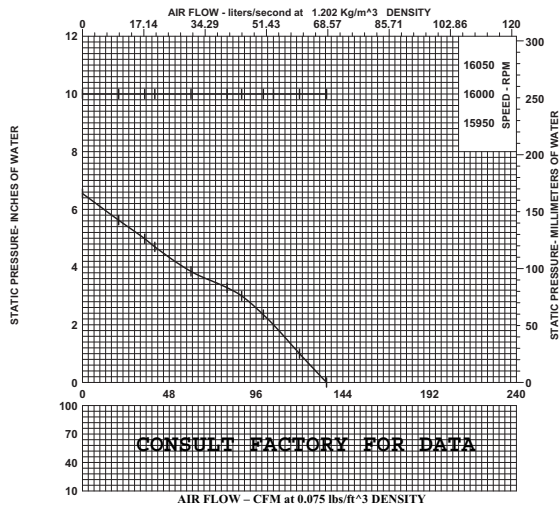

Specifications subject to change without notice



Rotron / Airscrew



NOTES:

---

**North America**

T: +1 845-679-1361  
F: +1 845-679-1870

**United Kingdom**

T: +44 (0) 1932 765822  
F: +44 (0) 1932 761098

[www.ametekaerodefense.com](http://www.ametekaerodefense.com)

*Specifications subject to change without notice*

**Europe**

T: +49 8145 951767  
F: +49 8145 951768

**Asia Pacific**

T: +65 6484 2388  
F: +65 6481 6588

Contact E-mail: [milinquiry@ametek.com](mailto:milinquiry@ametek.com)